

MS815 V8.0 Technical Specification

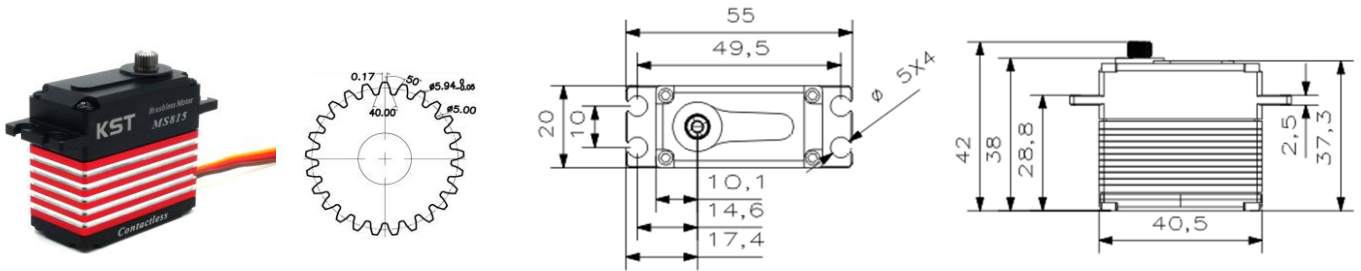

25T 6mm Output Shaft Spline

1. Operating Data

| | |
|----------------------|--------------------|
| Rated Voltage | DC7.4V |
| Voltage Range | DC6.0V-8.4V |
| Stalling Torque | 15Kgf.cm@6.0V |
| | 18Kgf.cm @7.4V |
| | 20Kgf.cm @8.4V |
| No-load Speed | 0.09sec/60°@6.0V |
| | 0.08sec/60°@7.4V |
| | 0.07sec/60°@8.4V |
| Working Frequency | 1520us/333Hz |
| Default Travel Angle | ±100°=200° Total |
| Temperature Range | -20°C.....+65°C |
| Soft Start | Programmable |
| Programmable | Yes |
| Case Material | Aluminum Alloy |
| Motor Type | Brushless DC Motor |
| Gear Set Material | Hardened Steel |
| Position Sensor | Contactless |
| Case Dimensions | 40.5*20*38mm±0.2mm |
| Weight | 70g±10% |

2. Performance

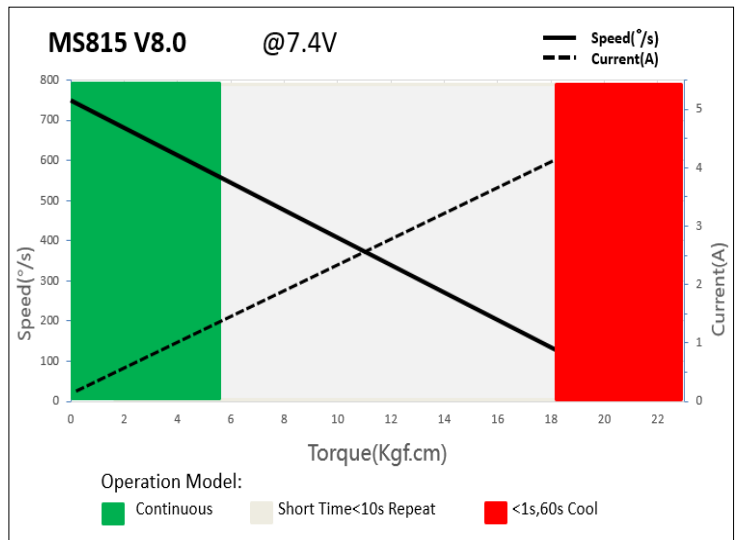

3. Command signal PWM Command Interface

| | |
|----------------------------|---|
| Signal Voltage | HIGH: min.3.3V, max.5.0V Low: min.0.0V, max.1.5V |
| Pulse Lengths | 500us-2500us |
| Pulse Lengths for Position | 500us/1500us/2500us -100° 0°/+100° |

4. Electrical Connection

| 3 2 1 | Pin Assignment | | | |
|-----------|----------------|--------|--------|----------------|
| | 1 | Orange | Signal | PWM Command |
| | 2 | Red | DC+ | Supply Voltage |
| | 3 | Brown | DC- | Supply Ground |